



NUS
National University
of Singapore

College of Design
and Engineering

ARCHITECTURE

BACHERLOR'S DEGREE
PROGRAMME





NUS Architecture

Singapore's Premier Architectural Programme

Why NUS Architecture?

Welcome to NUS Architecture, the crown jewel of design, architecture, landscape and urbanism in Asia. Here, we're not just about buildings; we're about building futures. Led by a multidisciplinary and international faculty, we champion design excellence under the vision of 'Architecture for Asia'. Nestled in the vibrant heart of Asia, and basking in the endless summer of the tropics, we tackle the unique challenges and opportunities that our equatorial climate brings.

Renowned for supporting cutting-edge architectural practice and research all within the dynamic tapestry of Asia, NUS Architecture holds a long-standing reputation as Asia's leading architecture school and ranks among the top ten schools worldwide for excellence in professional architectural education. Our mission is to cultivate inspired designers, knowledgeable practitioners and socially

engaged citizens. Situated within the stimulating environment of a top-tier research university, we marry rigorous academic inquiry with bold creative exploration, aiming to solve the puzzles of our contemporary built environment.

Imagine studying in a place where you're at the crossroads of the world's most bustling urban landscapes. Our Singapore campus offers first-hand experience of the ebb and flow of Asia's bustling urban centres, as well as unparalleled opportunities in a vibrant 21st century capital city.

Our alumni are the proof that what you do here, truly matters. From the masterminds behind Singapore's iconic skylines to the winners of the prestigious President's Designer of the Year Award, our graduates are the architects of tomorrow. Their work shapes not only Singapore but the entire region's built environment, making a difference in the quality of life for millions now and in the future.

What does the Bachelor of Arts (Architecture) degree entail, how long does it last, and who should participate?

The BA (Arch) is a preeminent four-year Honours degree programme that serves as the core foundation for concurrent Master's programmes offered by NUS Architecture.

At the heart of the BA (Arch) curriculum is design excellence. From the get-go, students will dive into studio research, exploration and creation, crafting their skills in drawing, model-making and visual storytelling. But it's not all about the drafting table; students also get to immerse themselves in the liberal arts, exploring architectural history, theory and the nuts and bolts of buildings—tectonics, systems and technologies. These first three years are our students' playground for discovery, laying the groundwork for tackling the built environment's biggest puzzles.

In the first year, students will get hands-on with projects that challenge them to think differently about design,

representation and critical thinking. It's all about building the foundations in environmental design, space, precedent, materiality and the unique considerations of our equatorial environment.

As students move into their second and third years, the complexities of the architectural world unfold. They will navigate the intricacies of structure, site, programme and envelope, delving into sophisticated architectural formations. The fourth year is designed to broaden their horizons in cultural, aesthetic and construction fronts.

This sequence encourages independent thinking and creativity, all while gearing students up for the next level of architectural research and practice.

“Engaged in cutting-edge practices, research, and teaching, the department is committed to design and planning innovations to meet the planet’s many new and growing challenges.”

JEFF HOU, Ph.D, FASLA
 Provost’s Chair Professor and
 Head of Department



Image credit:
 (Right) Ni Kechun (Amy)
 (Below) Tan Wan Theng
 (Opposite) Ryan Ho Zi Hao

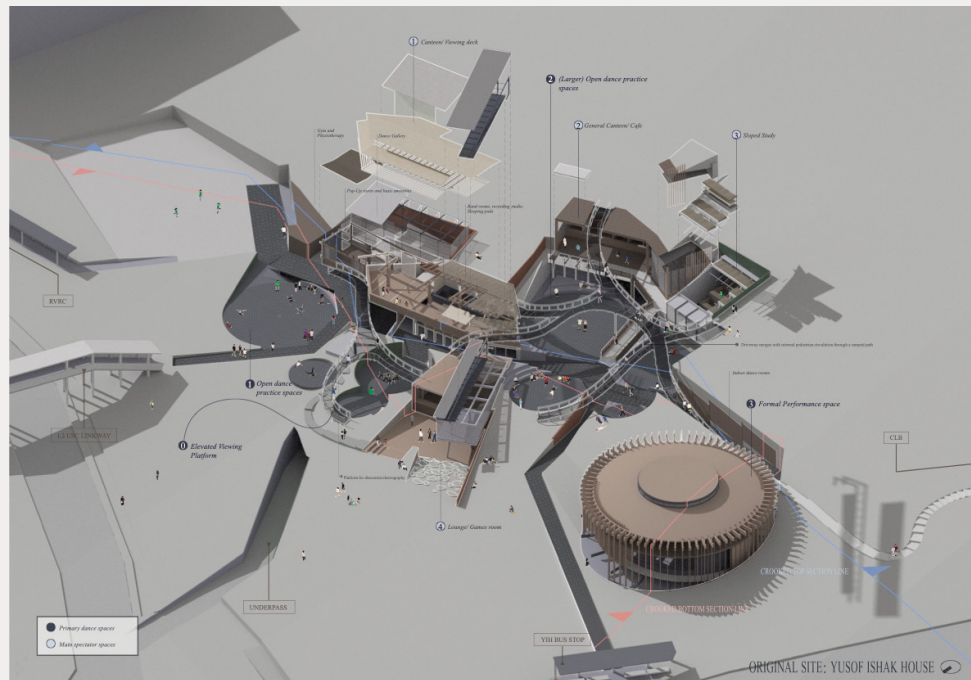

The BA Arch foundation programme is set within a broad-based interdisciplinary education model. It provides a strong disciplinary foundation and at the same time encourages students to expand their horizons and worldviews beyond the confines of the discipline. Ultimately, students are encouraged to draw on expertise and knowledge both within the Department and across the University. This allows students to align their design education with their own specific areas of interests. By offering a wide range of opportunities and offering comprehensive training in both discipline-specific and general education, our programme prepares students to be able to navigate a complex and multivariate future. This prepares them to become influential citizens and visionary thought leaders, not only within the field of architecture but in other various domains.

“Studios and hands-on workshops are accompanied by seminars covering areas of history and theory, urbanism, and the environment. Fusing criticality and embracing engineering skillsets, we welcome students ready to creatively and critically employ technology to shape the future.”

FEDERICO SIMONE RUBERTO, Ph.D
 Senior Lecturer
 Bachelor of Arts in Architecture
 Programme Director



View the programme
 overview here



Get First-Hand Insights: Connect with Our Students Through TAS!

TAS serves as the bridge between students and the school, ensuring that student voices are heard and valued. TAS also fosters connections with the industry and the Singapore Institute of Architects (SIA), supporting initiatives tailored to students and enhancing academic life, creating a more cohesive learning environment.

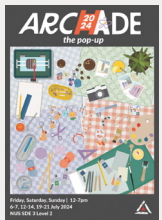

Get in touch with TAS!

@thearchitectureociety
Facebook: The Architecture Society

@thearchitectureociety_
enquiry@tas.org.sg



Our Alumni



Ryan Quah Kun Hao
Master of Architecture,
Class of 2024
Lee Kuan Yew Gold Medal,
2024
Architectural Associate,
DP Architects

The Bachelor of Arts in Architecture at NUS is a course for the daring and adventurous. It exposes students to a wide range of challenges and introduces them to diverse design methodologies and skill sets. Through its process-driven curriculum, the programme fosters the development of critical analysis and thinking skills, crucial for tackling any complex project with confidence. My time in the programme has not only expanded my comprehension of architecture but has also emboldened me to approach design tasks with newfound enthusiasm and creativity.

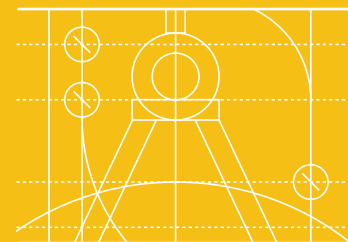

Larry Yeung

Master of Architecture,
Class of 2014
Executive Director of Participate
in Design (PID), a non-profit
design organisation that helps
neighbourhoods and public institutions design
community-owned spaces and solutions

Covering diverse areas such as architectural design, community design, and project management, the curriculum for the Bachelor of Arts in Architecture provided me with a comprehensive skill set that responds to an ever-complex and rapidly changing society. One of the unique strengths of this programme lies in its global perspective and opportunities. The platform provided by NUS allowed me to go beyond the confines of Singapore, enabling me to explore and network with diverse communities. Coupled with the guidance of exceptional faculty, it has not only shaped my understanding of architecture but has also instilled in me a sense of responsibility to contribute positively to the built environment.



Ar Lim Shing Hui

Master of Architecture,
Class of 2008
Founder & Design Principal
of L Architects, an inter-
disciplinary architectural design
practice based in Singapore

The Architecture programme at NUS provided an exceptional platform for exploring design through a forward-thinking, innovative lens. The curriculum champions creativity, critical thinking, and interdisciplinary collaboration, fostering an environment where ideas flourish. My journey was both intellectually stimulating and profoundly rewarding, offering countless opportunities for artistic exploration and professional development. Through this experience, I honed a refined design sensibility and gained a comprehensive understanding of architecture's global complexities, equipping me with the tools to shape the future of the built environment.

Admission Requirements

To be considered for admission to the BA (Arch) programme, candidates must hold one of the following qualifications:

Singapore-Cambridge GCE 'A' Level

A pass in H1 Chemistry or Mathematics or Physics; OR

A pass in GCE 'O' Level Additional Mathematics.

The indicative grade profile of 'A' Level applicants offered placement in Architecture in AY2023/2024 is 90th percentile: AAB/C and 10th percentile: CCC/B.

Polytechnic Diploma

(Excluding Advanced Diplomas/Specialist Diplomas/Certificate Courses)

A pass in GCE 'O' Level Elementary Mathematics.

Applicants who do not fulfill this minimum requirement but have obtained the relevant Graduate DDP Transcripts/Certificate in University Preparatory Mathematics depending on the Polytechnics would be deemed as having met the Mathematics requirement.

International Baccalaureate (IB) Diploma

A pass in SL Chemistry or SL Mathematics: Analysis and Approaches or SL Physics; OR

A pass in HL Mathematics: Applications and Interpretation.

NUS High School Diploma

A good major CAP in Chemistry or Mathematics or Physics.

International Qualifications

A pass in Year 12 or Higher Level Chemistry or Mathematics or Physics or Physical Science.

For international students and detailed admission requirements, please refer to www.nus.edu.sg/oam.

Shortlisted candidates will be invited to sit for the Admission Aptitude Test (AAT) and attend an interview as part of the selection process for admission.



Contact

🌐 cde.nus.edu.sg/arch

☎ +65 6516 8736

✉ askdoa@nus.edu.sg
